



**CLOVER**  
RETURNS MANAGEMENT  
SOLUTIONS

## **FW0304A0US CERTIFIED-REFURBISHED USER MANUAL**

### **Important Information About Your Refurbished Product**

**Notice to Customers:** This product has been refurbished by Clover Environmental Solutions, LLC dba Clover Returns Management Solutions. We are committed to providing high-quality refurbished household products to meet your needs.

**Warranty Information:** Please note that the warranty terms outlined in the attached original equipment manufacturer (OEM) documentation do not apply to this remanufactured product. For all warranty claims or inquiries, please visit [www.refurbproductsupport.com](http://www.refurbproductsupport.com) to submit your request or obtain further information.

**Terms and Conditions:** Any terms and conditions set forth in the attached original OEM documentation may not apply to this remanufactured item. For the specific terms applicable to your purchase, please refer to the documentation provided at the time of purchase or visit [www.refurbproductsupport.com](http://www.refurbproductsupport.com)

### **Additional Information:**

- **Safety Notice:** Ensure you follow all safety instructions provided in the OEM documentation as they remain applicable to the safe operation of this remanufactured product.
- **Recycling and Disposal:** For information on proper disposal or recycling of this product please visit the manufacturer's website.

**Contact Us:** If you have any questions or concerns about your refurbished product, please reach out to us via:

Website: [www.refurbproductsupport.com](http://www.refurbproductsupport.com)

Email: [productsupport@cloveres.com](mailto:productsupport@cloveres.com)

Phone: (844) 745-0760

This cover sheet is being provided to ensure clarity regarding the status and support of your refurbished product. The attached OEM documentation is provided for reference only.



## **iFLOOR 3 BREEZE SERIES** Compact Cordless Floor Washer

Instruction Manual

Manual De Uso

Mode D'emploi



\*Actual product may differ from illustration.

**TINECO IS HERE TO HELP.**

We'll get back to you within 24 hours.



 [www.tineco.com](http://www.tineco.com)

 1-855-292-8864

**A**

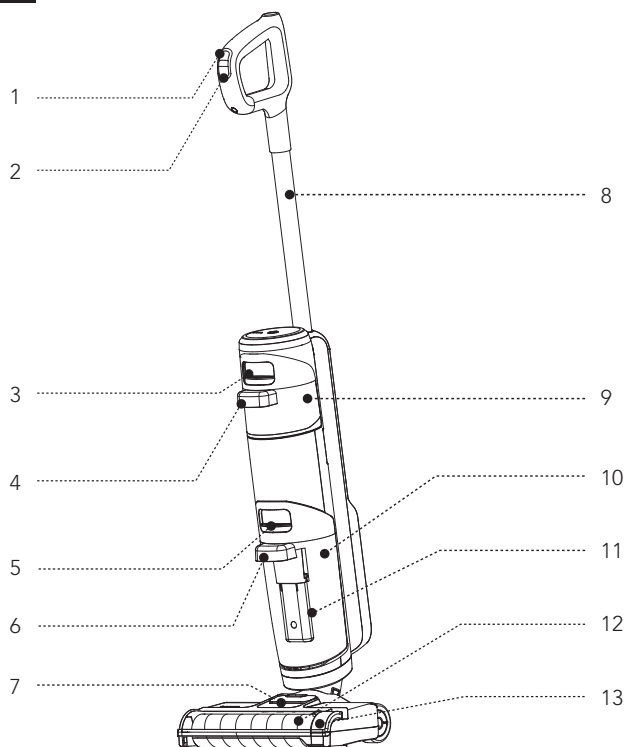

14



15



16

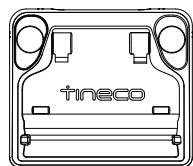

17

**B-1**

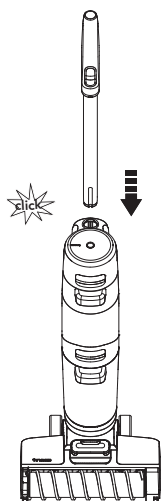

**B-2**

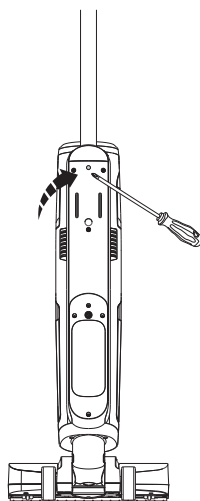

C-1

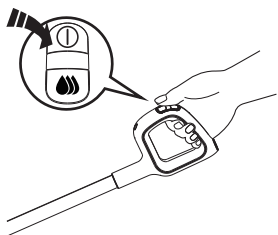

C-2

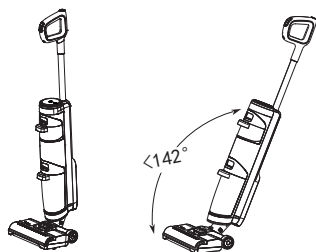

C-3

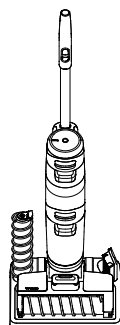

C-4

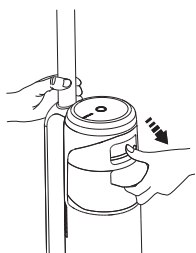

C-5

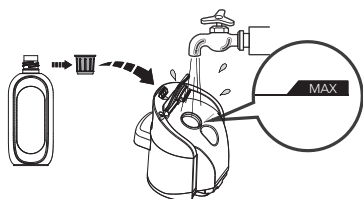

C-6

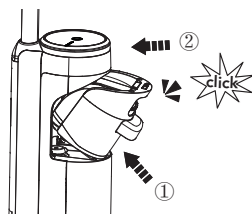

C-7

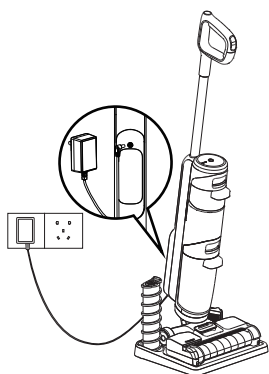

D-1

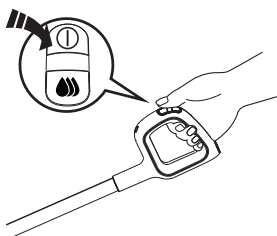

D-2

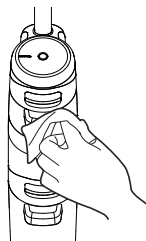

### D-3

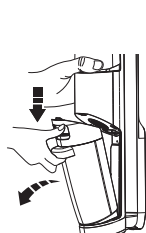

①

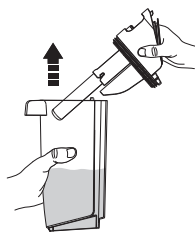

②



③



④

### D-4

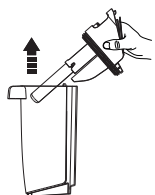

①

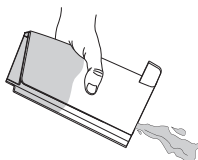

②

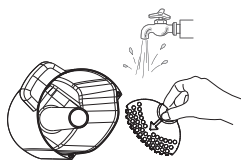

③

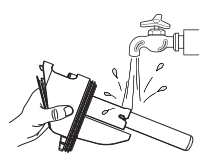

④

### D-5

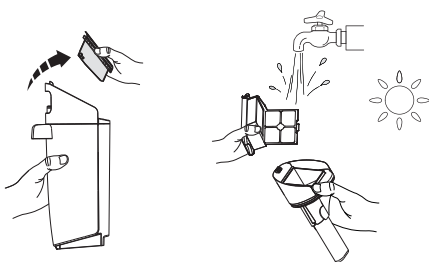

### D-6

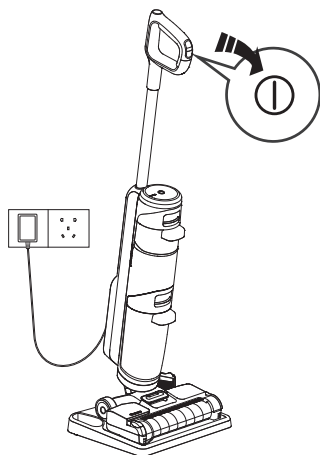

D-7

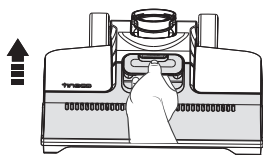

D-8

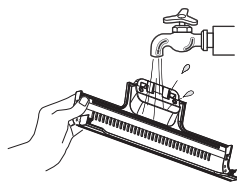

D-9



D-10

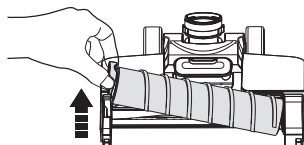

D-11

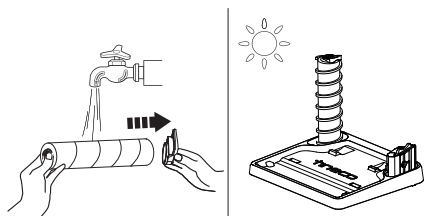

D-12

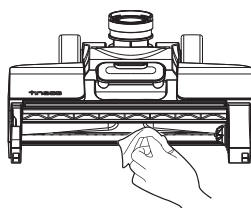

D-13

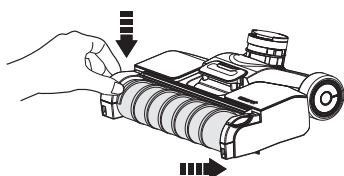

E-1

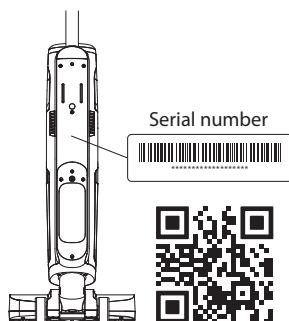

# CONTENTS

Important Safety Instructions.....	5
Specifications .....	8
Overview.....	8
Assembly .....	8
Operation .....	9
Maintenance .....	10
Troubleshooting.....	11
Warranty .....	12

## IMPORTANT SAFETY INSTRUCTIONS

### SAVE THESE INSTRUCTIONS

#### Household use only.

When using an electrical appliance, basic precautions should always be followed, including the following:

**READ ALL INSTRUCTIONS BEFORE USING (THIS APPLIANCE).** Failure to follow the warnings and instructions may result in electric shock, fire and/or serious injury.

**WARNING** – To reduce the risk of fire, electric shock, or injury:

1. This appliance can be used by children aged from 8 years and above and persons with reduced physical, sensory or mental capabilities or lack of experience and knowledge if they have been given supervision or instruction concerning use of the appliance in a safe way and understand the hazards involved. Children should not play with the appliance. Cleaning and user maintenance shall not be performed by children without supervision.
2. The appliance is not to be used by persons (including children) with reduced physical, sensory or mental capabilities, or lack of experience and knowledge, unless they have been given supervision or instruction.
3. Use only indoors, on non-carpeted floor surfaces such as vinyl, tile, sealed wood, etc. Be careful not to run over loose objects or edges of area rugs. Stalling the brush may result in premature belt failure.
4. Do not allow to be used as a toy. Close attention is necessary when used by or near children, pets or plants.
5. Use only as described in this manual. Use only manufacturer's recommended attachments.
6. Do not use with a damaged cord or plug. If appliance has been dropped, damaged, left outdoors, dropped into water, or is not working as it should, return it to a service center.
7. Do not handle charger, including charger plug, and charger terminals with wet hands.
8. Do not put any object into openings. Do not use with any opening blocked; keep free of dust, lint, hair, and anything that may reduce air flow.
9. Keep hair, loose clothing, fingers, and all parts of your body away from openings and moving parts.
10. Use extra care when cleaning on stairs.
11. Do not use to pick up flammable or combustible liquids, such as gasoline, or use in areas where they may be present.
12. Do not pick up anything that is burning or smoking, such as cigarettes, matches, or hot ashes.
13. Do not use without filter.
14. Prevent unintentional activation. Ensure the switch is in the off-position before picking up or carrying the appliance. Carrying the appliance with your finger on the switch or energizing appliance that have the switch on invites accidents.
15. Always switch off the appliance before making any adjustments, changing accessories, or storing the appliance. Such preventive safety measures reduce the risk of starting the appliance

accidentally.

16. Recharge only with the charger specified by Tineco. A charger that is suitable for one type of battery pack may create a risk of fire when used with another battery pack.
17. Use appliances only with specifically designated Tineco battery packs. Use of any other battery packs may create a risk of injury and fire.
18. Under abusive conditions, liquid may be ejected from the battery; avoid contact. If contact accidentally occurs, flush with water. If liquid comes into eye contact, seek medical help. Liquid ejected from the battery may cause irritation or burns.
19. Do not use a battery pack or appliance that is damaged or modified. Damaged or modified batteries may exhibit unpredictable behavior resulting in fire, explosion or risk of injury.
20. Do not expose a battery pack or appliance to fire or excessive temperature. Exposure to fire or temperature above 266°F (130°C) may cause an explosion.
21. Follow all charging instructions and do not charge the battery pack or appliance outside of the temperature range specified in the instructions. Charging improperly or at temperatures outside of the specified range may damage the battery and increase the risk of fire.
22. Have servicing performed by a qualified repair person using only identical replacement parts. This will ensure that the safety of the product is maintained.
23. This appliance contains battery cells that are non-replaceable. Do not modify or attempt to repair the appliance or the battery pack except as indicated in the instructions for use and care.
24. Always turn off this appliance before connecting or disconnecting the motorized nozzle.
25. Do not charge or store the appliance outdoors or inside the car. Only charge, store or use the battery in a dry indoor area where the temperature is higher than 39.2°F (4°C) but lower than 104°F (40°C). The charger is for indoor use only.
26. Do not use to pick up ultrafine particles, such as lime, cement, sawdust, gypsum powder, or ashes.
27. Do not use to pick up sharp objects, such as metallic nails, pieces of glass, metal paper clips, or pins.
28. Do not use to pick up hazardous material and chemicals, such as solvent, drain cleaner, strong acids, or strong alkali.
29. Stop using immediately if the appliance is overheating, making unusual noises, producing unusual odors, performing low suction, or leaks electricity.
30. Turn cleaner OFF and disconnect from electrical outlet for long-term storage.
31. Always clean the Dirty Water Tank after each use to avoid potential blockage, which may lead to low suction power, motor overheating, or reduce the service life of the appliance.
32. Store appropriately indoors in a dry place after use.
33. Do not place or submerge appliance in standing water or try to clean flooded areas.
34. All data and technical instructions of this manual are based on results from lab tests of Tineco or designated third parties. The company reserves all rights for final explanations.
35. The plug must be removed from the socket-outlet before cleaning or maintaining the appliance.
36. A hazard may occur if the appliance runs over the supply cord.
37. Do not use the appliance when the water depth is more than 5mm above the surface.

## Range of Usage

1. The cordless hard floor cleaner is to be used on indoor hard floors, such as vinyl, tile, sealed wood, etc. Use on



- a rough surface may not get the best performance.
- 2. Keep your appliance away from heat sources, such as fireplace or heater, to avoid casing deformation.
- 3. Do not use to pick up flammable or combustible liquids, ultrafine particles, sharp objects, hazardous material, chemicals or anything that is burning or smoking, as described above.

## About Cleaning Solution

- 1. A large amount of cleaning solution entering into the motor may cause damage to the appliance.
- 2. Add solution as instructed in the Operation section. We recommend using the provided cleaning solution. Do not use the product with acidic, alkaline solution, or any substances harmful to the environment.
- 3. Keep out of the reach of children. Avoid contact with eyes and skin, otherwise, rinse thoroughly with water. If irritation persists, seek medical advice. If product is swallowed seek medical advice.
- 4. Dirty water and solution disposal should comply with local environmental regulations.

## About the Appliance

- 1. Do not modify or attempt to repair the appliance except as indicated in the instructions for operating and cleaning.
- 2. Charge the appliance with the Tineco adaptor. Input Voltage: AC 100-240V. Both high and low voltages can damage the adaptor, appliance, or even cause danger to the user.
- 3. Use extra care when cleaning on stairs.
- 4. Ensure that the Power Switch is in the OFF-position before picking up or carrying the appliance. Do not lay flat or lean the appliance so as to prevent dirty water from entering into the motor.
- 5. To avoid being tripped accidentally, please put away the appliance on the storage tray.

- 6. Always install the Dirty Water Tank and Clean Water Tank properly before use.
- 7. Do not allow the appliance or charger to get wet to avoid risk of fire or injury caused by a short circuit.

### TINECO/iFLOOR 3 BREEZE Series

This appliance complies with part 15 of the FCC Rules. Operation is subject to the following two conditions:

- (1) This appliance may not cause harmful interference, and (2) this appliance must accept any interference received, including interference that may cause undesired operation.

TINECO INTELLIGENT, INC.

1700 WESTLAKE AVENUE N., SUITE 200,  
SEATTLE, WA, 98109, USA

WWW.TINECO.COM

1-855-292-8864

**CAUTION:** Changes or modifications not expressly approved by the party responsible for compliance could void the user's authority to operate the equipment.

Note: This equipment has been tested and found to comply with the limits for a Class B digital appliance, pursuant to Part 15 of the FCC Rules. These limits are designed to provide reasonable protection against harmful interference in a residential installation.

This equipment generates uses and can radiate radio frequency energy and, if not installed and used in accordance with the instructions, may cause harmful interference to radio communications. However, there is no guarantee that interference will not occur in a particular installation. If this equipment does cause harmful interference to radio or television reception, which can be determined by turning the equipment off and on, the user is encouraged to try to correct the interference by one or more of the following measures:

- (1) Reorient or relocate the receiving antenna.
- (2) Increase the separation between the equipment and receiver.
- (3) Connect the equipment into an outlet on a circuit different from that to which the receiver is connected.
- (4) Consult the dealer or an experienced radio/TV technician for help.

## SPECIFICATIONS

Product	iFLOOR 3 BREEZE SERIES
AC Input	100-240V~
Voltage	21.6V==
Rated Power	190W
Running Time	≥20 mins
Charging Time	4-5 hrs
Water Flow Rate	30/100ml per min
CWT Capacity	0.6L
DWT Capacity	0.5L
Waterproof	IPX4

## Disposal

- The battery contains materials that are harmful to the environment and must be removed from the appliance before it is discarded.
- When removing the battery, the appliance must be powered off.
- Batteries, chargers, accessories and packaging should be sorted for environmental friendly recycling. Do not put them into fire, water or soil. Do not dispose of batteries and chargers into household waste! 
- If battery leakage contacts skin or clothing, immediately flush with water to avoid irritation and seek medical help.

## OVERVIEW

### Note:

Accessories may vary among markets. If you require more accessories, please go to [www.tineco.com](http://www.tineco.com) or [store.tineco.com](http://store.tineco.com).

- 1 Max Water Flow
- 2 Power On/Off
- 3 Clean Water Tank Release
- 4 Clean Water Tank Handle
- 5 Dirty Water Tank Release
- 6 Dirty Water Tank Handle
- 7 Brush Roller Cover Release
- 8 Tube
- 9 Clean Water Tank (CWT)
- 10 Dirty Water Tank (DWT)
- 11 Floater
- 12 Brush Roller
- 13 Brush Roller Cover
- 14 Deodorizing & Cleaning Solution
- 15 Dry Filter
- 16 Adaptor
- 17 Storage Tray

Fig.A

## ASSEMBLY

### How to Assemble/Disassemble

#### Note:

For water tank and brush assembly, please refer to "Operation" and "Maintenance".

- To assemble the handle, insert it into the appliance until you hear a click.

#### Fig.B-1

- In the event that the handle needs to be disassembled, press the spring to release the handle with a tool (like a screwdriver) and lift the released handle from the appliance.



#### Fig.B-2

## OPERATION

### Preparing for Use

- Before first use, please charge the appliance for 4-5 hours (refer to "Charging Instructions" for details).

\* Based on results from Tineco lab tests. Lab temperature 39.2°F (4°C) ~ 104°F (40°C).

1. Press  to turn on the appliance and press it again to turn off.
2. Press  to use Max water flow and the indicator blinks blue light.

**Fig.C-1**

3. The appliance will stop working when put upright and start running again when reclined.

\* Do not recline more than 142° to avoid water leakage.

**Fig.C-2**

4. Place the appliance on the storage tray vertically after use.

**Fig.C-3**

#### Note:

- Do not vacuum foamed liquid.
- To vacuum water left on the surface, the appliance will keep running for 3 seconds after power off.

### Filling Clean Water Tank

1. Press the Clean Water Tank release button to remove it from the appliance.

**Fig.C-4**

2. Open the tank cap, and fill with tap water to the Max line. When deep cleaning is necessary, add one bottle cap of solution to the CWT and tightly close the cap.

**Fig.C-5**

#### Note:

**Only use water under 140°F/60°C.  
DO NOT USE HOT WATER.**

3. Place the tank back into the appliance. You should hear a click if done correctly.

**Fig.C-6**

### Charging Instructions

Please charge the appliance when the indicator blinks red.

1. To charge the appliance, connect the external charging cord to the appliance and plug it into the wall outlet.
2. To avoid tripping hazards, please place the appliance on the storage tray near a wall during charging.

**Fig.C-7**

#### Warning:

- Only charge the appliance with the adaptor supplied by Tineco.
- During long periods of not being used, the appliance must be charged once every 3 months for optimal performance. It may take 4-5 hours for a full charge.
- Store indoors in a dry place. Do not expose the appliance to sunlight or freezing temperatures. Recommended temperature range: 39.2°F (4°C) ~ 104°F (40°C).

### Runtime

- The runtime is above 20 minutes, and using Max water flow won't affect the runtime.
- Estimated runtime data was obtained by Tineco Laboratory.

### Charging Time

- A full charge takes approximately 4-5 hours.
- Estimated data was obtained by Tineco Laboratory using ambient temperatures ranging from 39.2°F (4°C) to 104°F (40°C).

### Indicator

#### When in Use



Slowly blinking red light:  
low power.



Solid blue light: regular  
mode.



Blinking blue light:  
switching to Max water  
flow.



Off: no power or battery  
malfunction.



Solid red light: brush roller  
has a blockage or not  
installed.

## During Charging



Breathing blue light:  
charging.

## Fully Charged



Within 5 minutes of full  
charge: solid blue light.



After 5 minutes: light off.

# MAINTENANCE

## Note:

- For optimal performance and to prevent odors, always **clean** and **dry** DWT, floater, filters, brush roller, brush roller cover **completely** after each use.
- Please make sure each part is installed correctly or the appliance may not work properly.
- After maintenance, place the appliance on the storage tray vertically. Do not expose the appliance to direct sunlight, and store it indoors in a dry place.

## Main Body

- 1.To reduce the risk of injury, switch off before performing maintenance.

Fig.D-1

- 2.Use a cloth to clean the surface with a neutral detergent. The cloth should be dry to prevent water from entering the appliance.

Fig.D-2

## Dirty Water Tank

- 1.When dirty water reaches the Max line, the floater will block off the DWT and create a high pitched sound indicating it's time to switch off the appliance.
- 2.Pull up the tank lid to empty the DWT. Rinse the inside of the DWT and place back into the appliance.

Fig.D-3

## Filter & Floater

- 1.If the filter and the floater have been blocked, rinse with water.
- 2.Remove the filter from the tank lid, remove the floater, and rinse both parts with water.

Fig.D-4

## Dry Filter

- Grasp recessed area on each side of the dry filter and pull upward. Rinse under running water and must be completely dry before recombining with the lid of the DWT.

Fig.D-5

## Self-cleaning

- 1.Place the appliance on the storage tray and plug in. Press and hold ① for 3s and begin the self-cleaning process.
- 2.Once complete, the appliance will begin charging. Clean the Dirty Water Tank after cleaning completed.

Fig.D-6

## Note:

- Ensure the appliance is plugged in.
- Before self-cleaning cycle, please clean the DWT and ensure the water level in the CWT exceeds 40%.

## Brush Roller Cover

- 1. Grab the front handle while pressing the button and pull upward to remove.

Fig.D-7

- 2. Rinse with water.

Fig.D-8

- 3. While replacing, always latch the brush cover into place to avoid leakage.

Fig.D-9

## Brush Roller

- 1. Remove the brush roller by grabbing the brush roller tab and pulling upward.

Fig.D-10

- 2. Remove the hair and debris wrapped around the roller and rinse with water (brush roller tab can be removed). Replace the brush roller back onto the storage tray, and allow it to dry completely before reinstalling.

Fig.D-11

- 3. Remove hair and debris from the brush roller chamber and the opening with a tissue or a damp cloth.

Fig.D-12

- 4. Replace the brush roller by inserting the brush roller end into the right side of the holder, then lock the pull tab into place by pressing downward.

Fig.D-13

### Note:

To maintain optimal performance, replace the brush roller every 6 months.

## TROUBLESHOOTING

Problem	Solution
The appliance does not turn on	Charge the appliance
Weak suction	Empty the dirty water and then reinstall the DWT
	Clean the filters
	Remove blockages
	Too much wear of brush roller, please replace it
Abnormal motor sounds	Remove blockages
	Empty the dirty water and then reinstall the DWT
Appliance won't charge	Use the original adaptor
	Replug in the adaptor correctly
Air outlet cover is leaking water	Install the floater and the dry filter correctly
	Empty the dirty water and then reinstall the DWT
	Allow the dry filter to dry completely
	Remove blockages

### Note:

If the above troubleshooting guide fails to provide a solution, please visit our website [www.tineco.com](http://www.tineco.com) for further support.

# WARRANTY

## 2-YEAR LIMITED WARRANTY

- Only applies to purchases made from authorized retailers of Tineco.
- Is subject to the adherence of the requirements outlined in this instruction manual, and is subject to further conditions outlined below.
- This warranty is governed by and construed under the laws of the country in which the purchase took place. We provide 2-year warranty or a warranty period as stipulated by applicable local law, whichever is longer.

## WHAT IS COVERED?

- Your Tineco appliance has a 2-year warranty against original defects in material and workmanship, when used for private household purposes in accordance with the Tineco Instruction Manual. Motorized accessories and battery bought separately come with a 1-year warranty.
- This warranty provides, at no extra cost to you, all labor and parts necessary to ensure your appliance is in proper operating condition during the warranty period.
- This warranty will only be valid if the appliance is used in the country in which it was sold.

## WHAT IS NOT COVERED?

Tineco shall not be liable for costs, damages or repairs incurred as a result of:

- Appliances purchased from an unauthorized dealer.
- Careless operation or handling, misuse, abuse and/or lack of maintenance or use not in accordance with the Tineco Instruction Manual.
- Use of the appliance other than for normal domestic purposes, e.g. for commercial or rental purposes.
- Use of parts not in accordance with the Tineco Instruction Manual.
- Use of parts and accessories other than those produced or recommended by Tineco.

- External factors unrelated to product quality and use, such as weather, modifications, accidents, electrical outages, power surges or acts of God.
- Repairs or alterations carried out by unauthorized parties or agents.
- Failing to clear blockage and other hazardous material from the appliance.
- Normal wear and tear, including normal wearing parts, such as clear bin, belt, filter, HEPA, brush bar, and power cord (or where external damage or abuse is diagnosed), carpet or floor damage due to use not in accordance with manufacturer's instructions or failure to turn the brush bar off when necessary.
- Reduction in battery discharge time due to battery age or use.

## WARRANTY LIMITATIONS

- Any implied warranties relating to your appliance including but not limited to warranty of merchantability or warranty of fitness for a particular purpose, are limited to the duration of this warranty.
- Warranty coverage applies to the original owner and to the original battery only and is not transferable.
- This limited warranty gives you specific legal rights. You may also have other rights which vary by region.
- Manufacturer's warranties may not apply in all cases, depending on factors such as use of the product, where the product was purchased, or who you purchased the product from. Please review the warranty carefully, and contact the manufacturer if you have any questions.

## WARRANTY SERVICE

### Register:

- We highly recommend that upon purchase, you register your appliance by logging into our official website ([www.tineco.com](http://www.tineco.com)) or scanning the QR code to enjoy more exclusive benefits. To register, please enter the whole serial number (found on the back of the appliance).

### Fig.E-1

- Failure to register your product won't diminish your warranty rights.

**How to Claim:**

- Please retain your proof of purchase. To make a claim under our Limited Warranty, you need to provide your serial number and the original purchase receipt with the purchase date and order number on it.
- All work will be carried out by Tineco or its authorized agency.
- Any replaced defective parts will become the property of Tineco.
- Service under this warranty will not extend the period of this warranty.

Contact our Customer Service  
Hotline: **1-855-292-8864**  
or Visit Tineco website  
**[www.tineco.com](http://www.tineco.com)**  
for expert customer service.